



Sealine S330 - 2015

170.000 €

| | | | | | |
|--------|----------|-------------|-------------------------------|------------|--------|
| Length | 10,31 m. | Disp.. | 6.14 t | Speed | 30 kts |
| Beam | 3,5 m. | Engines | 2x 220 HP Volvo Penta Joystik | Cabin / Wc | 2 / 1 |
| Draft | 0,98 m. | Engine Hour | 132 | Location | Bodrum |

Description

British design, German engineering work Sealine S330 stands out with its sportive structure and wide range of uses. It has two spacious cabins, a dining table that can be transformed into a bed, a WC and a kitchen, with equipment and layout that can meet the needs. It provides ease of use in marina berthing and departing with the use of joysticks. Fully equipped.

Navigation & Cruising Equipments

Raymarine GS95 Touch Chartplotter
 Raymarine Autopilot
 Raymarine I 70 multifunction display
 Raymarine VHF 260
 Compass

Multimedia & Entertainment

Fusion Bluetooth Sound System
 Fusion Cockpit Speakers
 Cockpit remote Fusion

12-220 V Electrics

Generator 3.4 kVA (Whisper Power)
 Charger (Victron Energy)
 Service & engine battery
 220V Shore Power

Deck & Outside Equipments

Teak cockpit , platform, side ways
 Soft Top Roof
 Lenco Flap
 Bimini
 Searchlights
 Front window (pfeifer)
 Sunbad
 Fridge
 Sink
 BBQ
 Cockpit Shower
 Camper Canvas
 Ultra anchor 16 Kg 60m chain

Additional Equipments

Volvo Joystick control
 Tender + 2.3 Honda Engine
 Aircondition (Cruisair)
 Bowthruster (Quick)
 Swimming ladder
 Underwater lights
 Chain Counter (Quick)

Galley

Fridge
 Sink
 Stove

Layout

2 Cabin + 1 wc

Tanks

Fuel: 570 Litre
 Water: 220 Litre

Notes

Turkish Flag

















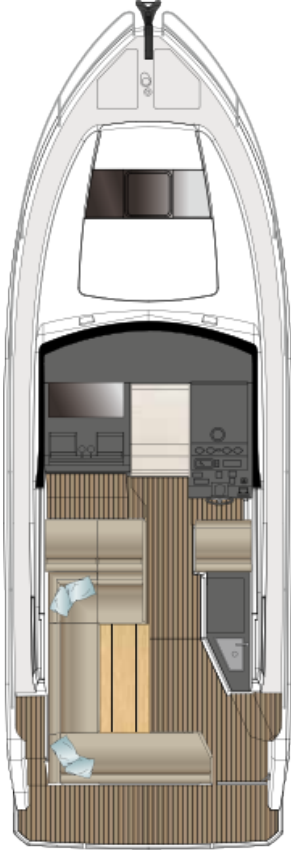

MAIN DECK



LOWER DECK

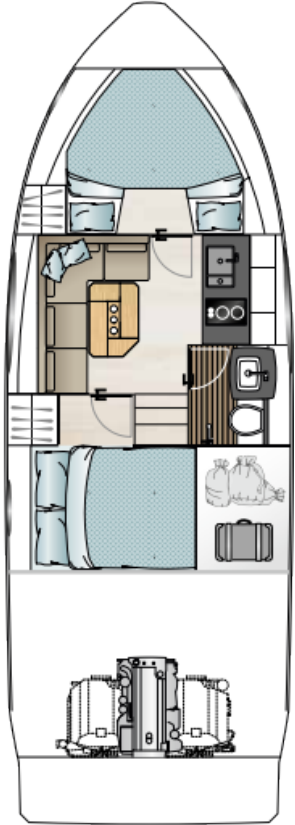

LOWER DECK
optional

Can Arslan

+90 534 366 60 80 canarslan@canmarino.com

Can Oğuz

+90 532 710 88 58 canoguz@canmarino.com